

- Dimensions
- Mechanical Properties
- Application Data

ASME B18.3 : Hexagon Socket Flat Countersunk Head Cap Screws

Dimensions (inch)

Nom Size	P	S min.	R. S. Torque (in-lb)
#0	0.026 - 0.036	0.50	1.42
#1	0.028 - 0.040	0.62	2.52
#2	0.031 - 0.043	0.62	4.18
#3	0.033 - 0.046	0.62	6.33
#4	0.036 - 0.049	0.75	8.88
#5	0.037 - 0.051	0.75	13.1
#6	0.037 - 0.052	0.75	16.5
#8	0.039 - 0.055	0.88	30.1
#10	0.041 - 0.058	0.88	43.7
1/4	0.043 - 0.064	1.00	104
5/16	0.047 - 0.070	1.12	215
3/8	0.050 - 0.076	1.25	382
7/16	0.063 - 0.092	1.38	611
1/2	0.087 - 0.119	1.50	931
5/8	0.096 - 0.135	1.75	1722
3/4	0.105 - 0.150	2.00	3054
7/8	0.118 - 0.165	2.25	4928
1"	0.130 - 0.181	2.50	7388
1-1/8	0.140 - 0.196	2.81	10464
1-1/4	0.150 - 0.212	3.12	14766
1-3/8	0.162 - 0.228	3.44	19360
1-1/2	0.173 - 0.243	3.75	25692

Mechanical Properties

Nom. Size, D	D ≤ 1/2	D > 1/2
Hardness (HRC)	39-44	37-44
Tensile Strength (psi)	145,000 min.	135,000 min.
Decarburization and Carburization (See Page 34)	E = 3/4H1	E = 3/4H1

• Typical Application Fixture

Flat socket head cap screws are designed for use in applications where the head cannot protrude above the mating parts. They are set in countersunk holes and the top of the head is flush with the surface of the assembly.

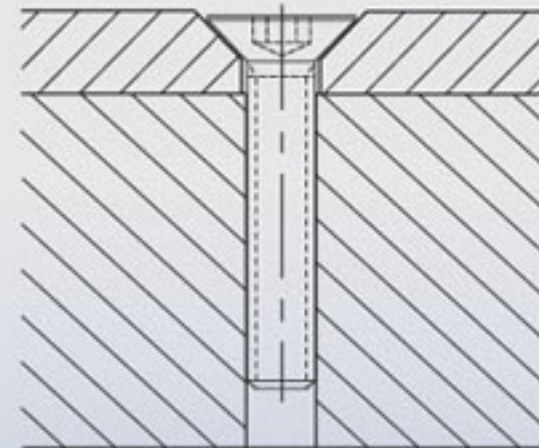

• Protrusion Height Gauge

